

**SPECIFICATIONS**

Current Rating: 5A AC,DC  
 Voltage Rating: 250V AC Max.  
 Operating Temp.: -25°C~+85°C  
 Contact Resistance: 10 Milliohms Max.  
 Insulation Resistance: 1000 Megohms Min.  
 Dielectric Withstanding Voltage: 1500V AC,DC Min.  
 Contact: Brass, Tin Plated  
 Insulator: Nylon 66, UL 94V-0

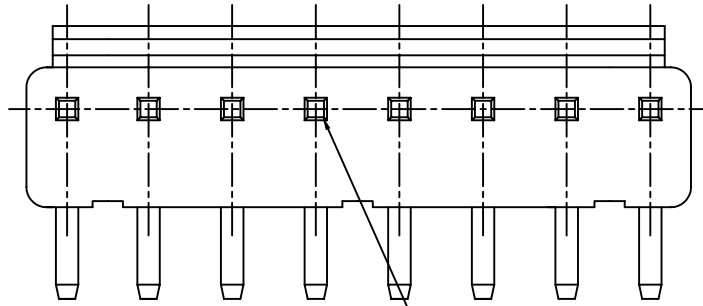

1.14SQ

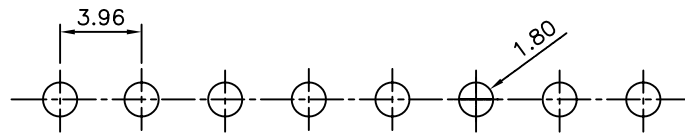
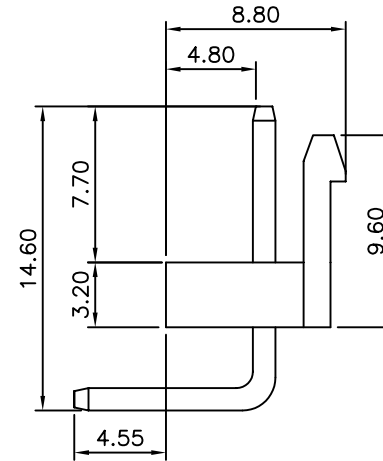
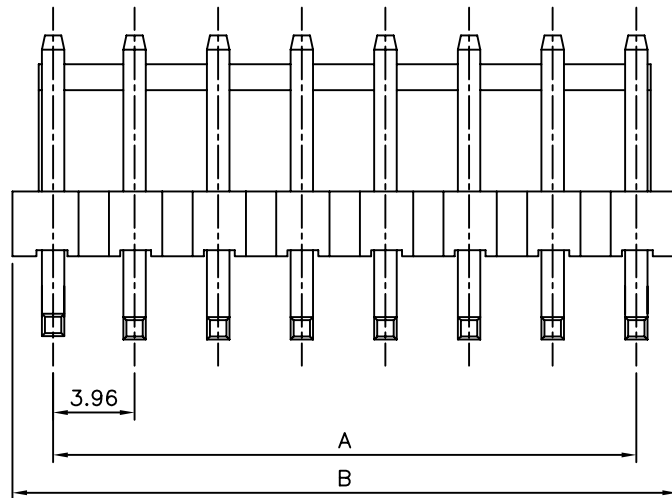

PCB Layout Component Side

Poles	A	B
02	3.96	7.92
03	7.92	11.92
04	11.88	15.84
05	15.84	19.84
06	19.80	23.80
07	23.76	27.88
08	27.72	31.74
09	31.68	35.86
10	35.64	39.90
11	39.60	43.84
12	43.56	47.92
13	47.52	51.72
14	51.48	55.92

DRAWING No.

0244JFDH03

APPROVED BY

MEI

CHECKED BY

BECKY

DRAWING BY

HZF

UNLESS OTHERWISE SPECIFIED

TOLERANCES ARE

.X ±0.5

.XX ±0.25

ANG.

SCALE

NONE

REV.

B0

UNIT  
mm

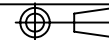

NO. REV.

B0 NEW RELEASE REVISIONS

BECKY CHK

02/08/2006 DATE